



CML3

Quick-start Guide



The purpose of this guide is to introduce the CML3 Portable Contamination Monitor and help you get started quickly and easily. We map the key areas of the interface and machine layout and take you through sample testing of both pressurised and unpressurised systems. Full instructions and support are available in the Operator's Manual at [mpfiltri.com](https://www.mpfiltri.com)

HYDRAULIC CONNECTIONS

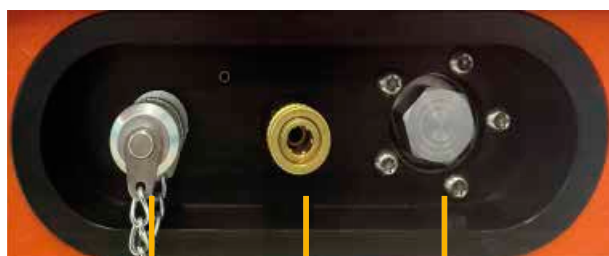

High pressure
M16x2 test point

Waste Outlet
quick-release coupling

Flow Control valve

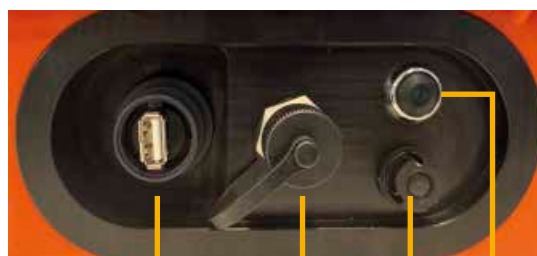

Power switch

DC charging port

USB C Connection port

USB data stick
download port

HEALTH AND SAFETY

Do not operate, maintain or carry out any procedure before reading the Operator's Manual. It is also important to comply with the current regulations related to occupational accident prevention and safety in the workplace.

Any individual operating the unit shall wear the following Personal Protective Equipment: Eyewear; Safety shoes; Gloves; Overalls (or other suitable protective clothing).

SUPPORT MATERIALS

MP Filtri is dedicated to offering comprehensive customer support with multimedia guides designed to help you master the device quickly and easily.

You can find all the tools you need at our website:
<https://www.mpfiltri.com/>

A full Operator's Manual is available

TECHNICAL SPECIFICATION

Particle Sizing

>4, 6, 14, 21, 25, 38, 50, 70 μ m

Particle Sizing

\pm 1 code

Operating Pressure

2 bar (29 PSI) to 420 bar (6091 PSI)

Reporting Standards

ISO 4406, NAS 1638
AS4059 Rev E, Table 1, 2
AS4059 Rev G, Table 1, 2
GBT 14039, GJB 420 B
GOST 17216, ISO 11218

Dimensions

Width: 352 mm (13.8")
Height: 149 mm (5.8") - not including handle
Depth: 297 mm (11.7")
Weight: 7.7 kg (17 lbs) - Device only

Data Storage

Approximately 4000 time-stamped tests in the integral memory
Full specification available in the Operator's Manual

CML3 MAIN SCREEN INTERFACE

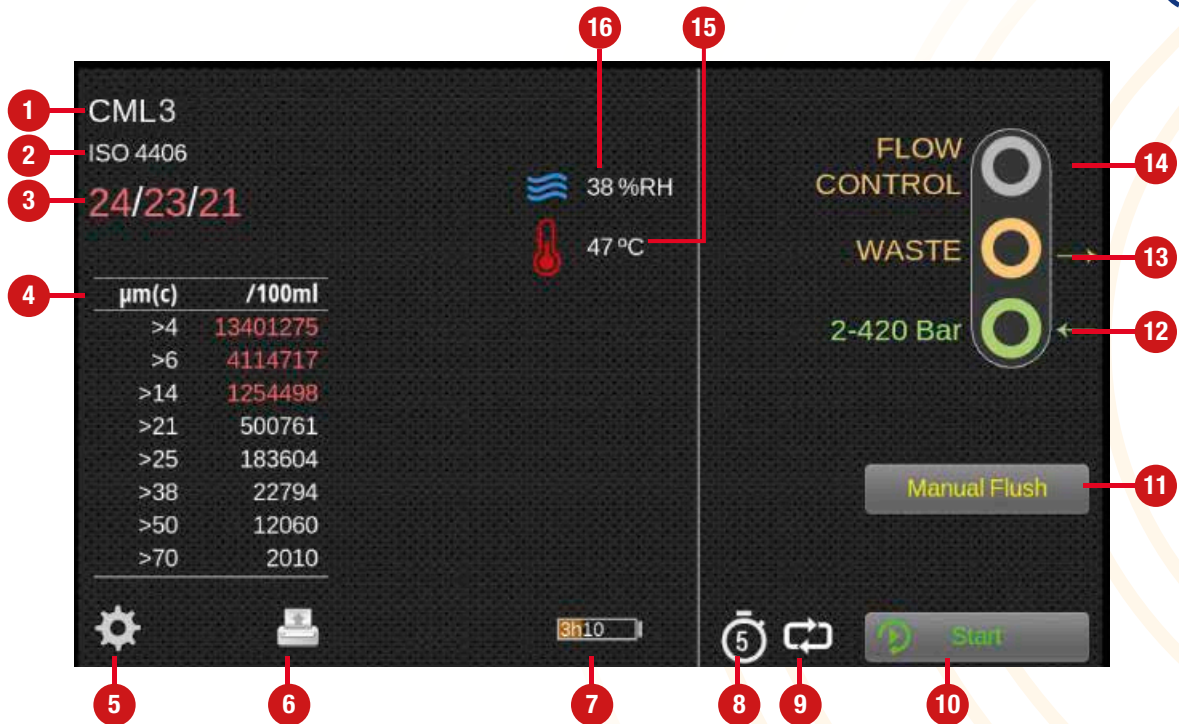

- | | | |
|----------------------------|-----------------------------------|------------------------|
| 1. Test reference | 7. Battery charge status | 13. Outlet port |
| 2. Test format | 8. Test time selection button | 14. Flow control valve |
| 3. Last test result | 9. Continuous/single test mode | 15. Temperature result |
| 4. Detailed results viewer | 10. Test start/stop button | 16. RH result |
| 5. Settings | 11. Manual flush operation button | |
| 6. Printer | 12. Inlet port | |

CML3 SETTINGS SCREEN INTERFACE

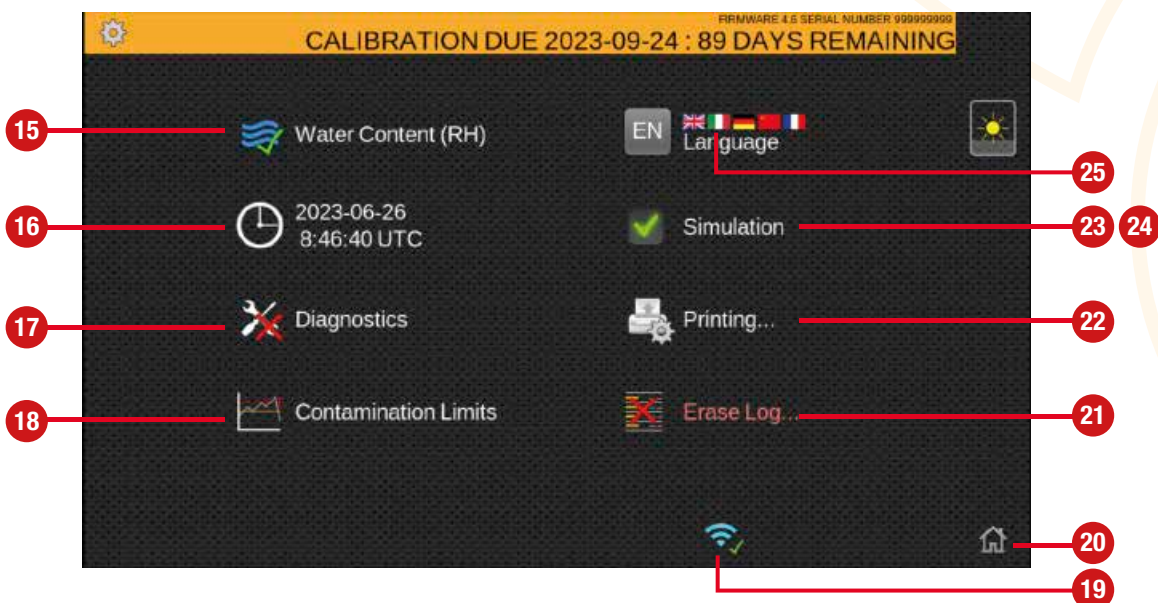

- | | |
|------------------------------------|------------------------|
| 15. RH test enabled | 21. Erase log |
| 16. Time settings | 22. Printer settings |
| 17. Diagnostics | 23. Simulation enabled |
| 18. Contamination tolerance limits | 24. Language |
| 19. Wifi enabled | 25. Brightness |
| 20. Home | |

1 STEP



Connect the waste hose to a waste receptacle and then connect to the CML3 waste outlet quick-release attachment.

2 STEP

Connect the hose to the CML3 high pressure inlet first then connect to the high pressure test point on the system.

3 STEP



The CML3 is now ready to take samples from pressurised systems. To begin sampling set the timer to 2, 5 or 10 minute test times by pressing on the Test time selection button.

4 STEP

CML3
ISO 4406
24/23/21

$\mu\text{m(c)}$	/100ml
>4	13401275
>6	4114717
>14	1254498
>21	500761
>25	183604
>38	22794
>50	12060
>70	2010



The results will appear on the main screen. You can also use the optional bluetooth printer to get a hard copy.

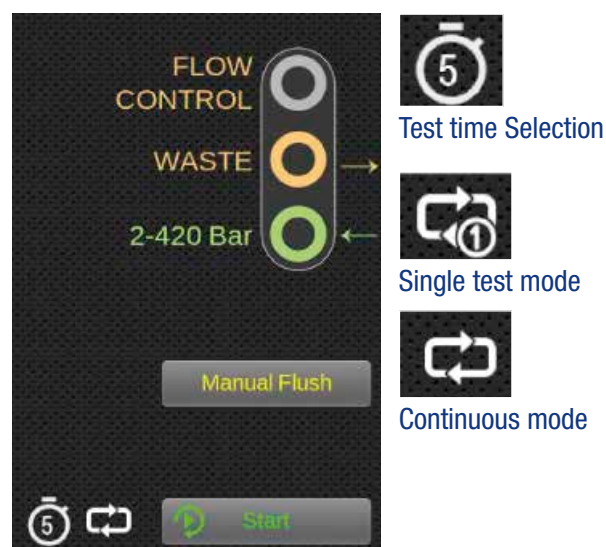

Press on the Single test/Continuous Mode Icon to choose your preferred test type.
Flow Control: The valve is designed to be removable to allow for any required cleaning operations.



Compatible with
CMP View

DIMENSIONS

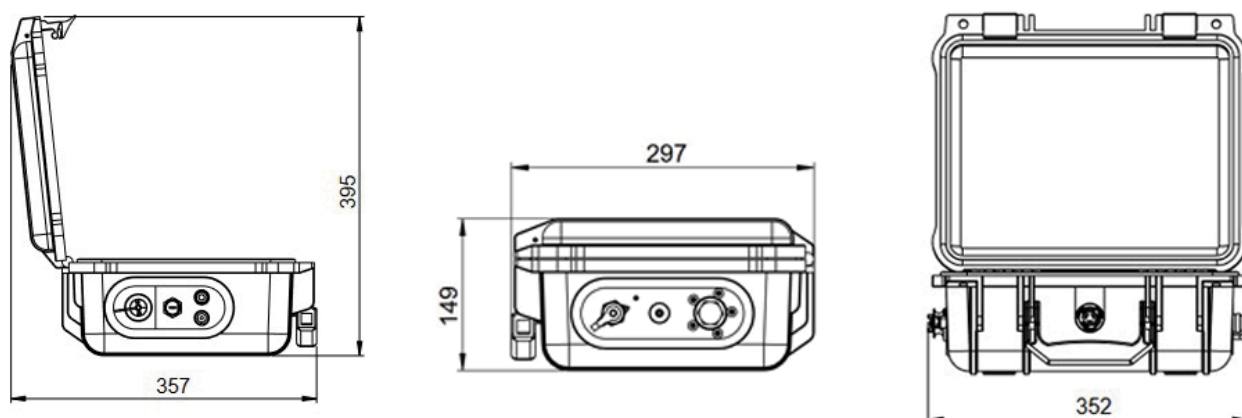

DOCUMENTATION

CONTAMINATION MONITORING PRODUCTS General catalogue



Download PDF

Scan or click me!

CMP View Software Quick Guide



Select your language and download PDF

Scan or click me!

CMP View Software Software multilingual

Download Software



Scan or click me!